

# Accepted Manuscript

A knowledge platform to inform on the effects of trawling on benthic communities

Alba Muntadas, Michel Lample, Montserrat Demestre, Johanna Ballé-Béganton,  
Silvia de Juan, Francesc Maynou, Denis Bailly

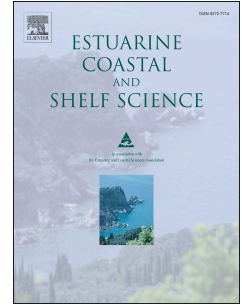

PII: S0272-7714(17)30003-3

DOI: [10.1016/j.ecss.2017.01.001](https://doi.org/10.1016/j.ecss.2017.01.001)

Reference: YECSS 5359

To appear in: *Estuarine, Coastal and Shelf Science*

Received Date: 16 March 2015

Revised Date: 5 September 2016

Accepted Date: 3 January 2017

Please cite this article as: Muntadas, A., Lample, M., Demestre, M., Ballé-Béganton, J., de Juan, S., Maynou, F., Bailly, D., A knowledge platform to inform on the effects of trawling on benthic communities, *Estuarine, Coastal and Shelf Science* (2017), doi: 10.1016/j.ecss.2017.01.001.

This is a PDF file of an unedited manuscript that has been accepted for publication. As a service to our customers we are providing this early version of the manuscript. The manuscript will undergo copyediting, typesetting, and review of the resulting proof before it is published in its final form. Please note that during the production process errors may be discovered which could affect the content, and all legal disclaimers that apply to the journal pertain.

1 A knowledge platform to inform on the effects of trawling on benthic  
2 communities

3 Alba Muntadas\*<sup>1</sup>, Michel Lample<sup>2</sup>, Montserrat Demestre<sup>1</sup>, Johanna Ballé-Béganton<sup>2</sup>,  
4 Silvia de Juan<sup>3</sup>, Francesc Maynou<sup>1</sup> and Denis Bailly<sup>2</sup>

5 <sup>1</sup>Institut de Ciències del Mar. Passeig Marítim de la Barceloneta 37-49.08003,  
6 Barcelona

7 <sup>2</sup>Université de Brest, UEB, UMR AMURE, 12 rue du Kergoat, CS 93837, 29238 Brest  
8 Cedex 3, France

9  
10 <sup>3</sup>Center for Marine Conservation, Estación Costera de Investigaciones Marinas-  
11 Facultad de Ciencias Biológicas, Pontificia Universidad Católica de Chile, Casilla 114-  
12 D, Santiago, Chile.

13 \*Corresponding autor: Alba Muntadas. Institut de Ciències del Mar. Passeig Marítim  
14 de la Barceloneta 37-49. 08003 Barcelona. [amuntadas@icm.csic.es](mailto:amuntadas@icm.csic.es). Tel: +34 93 230  
15 95 00-FAX: +34 93 230 95 55

16

17 GRAPHICAL ABSTRACT

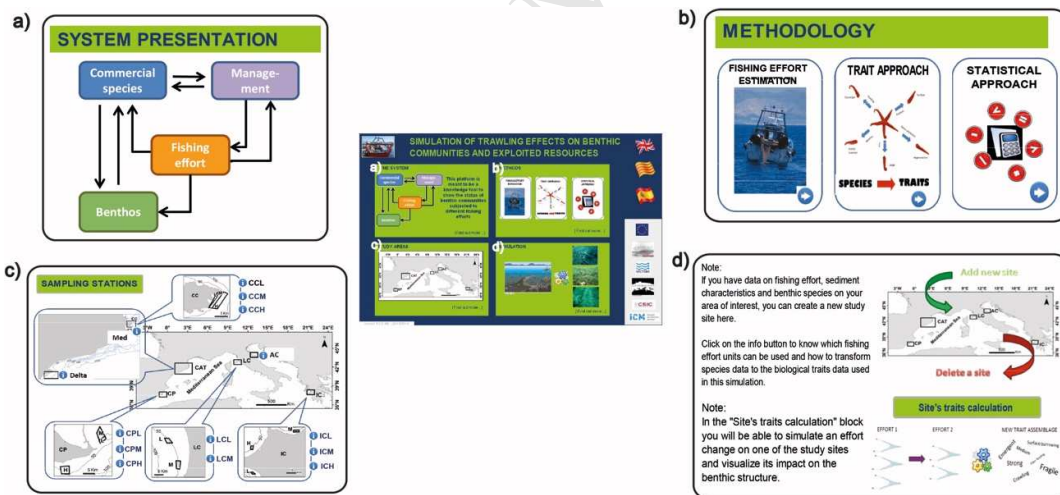

18

19 ABSTRACT

20 For a successful implementation of an Ecosystem Approach to Fisheries (EAF)  
21 management, it is necessary that all stakeholders involved in fisheries management  
22 are aware of the implications of fishing impacts on ecosystems and agree with the  
23 adopted measures to mitigate these impacts. In this context, there is a need for tools to

Download English Version:

<https://daneshyari.com/en/article/8885062>

Download Persian Version:

<https://daneshyari.com/article/8885062>

[Daneshyari.com](https://daneshyari.com)