

Design of End-effector for Tomato Robotic Harvesting

Guohua Wang, Yabo Yu, Qingchun Feng*

* National Research Centre of Intelligent Equipment for Agriculture/ Key Laboratory of Agri-informatics, Ministry of Agriculture/ Beijing Key Laboratory of Intelligent Equipment Technology for Agriculture, Beijing Research Centre of Intelligent Equipment for Agriculture, Beijing 100097, China
(Tel: 086-010-51503346; e-mail: fengqc@nercita.org.cn).

Abstract: In order to improve automatic harvesting for fresh-eating tomato, a new picking end-effector was designed, which mainly consisted of three parts, such as fruit holding, stem holding, and fruit separating. In view of the convenience of stemless fruit for transport and package, the end-effector separated the tomato fruit from the plant at the abscission layer between the stem and fruit. A sleeve with three equispaced gasbags was used as the flexible fruit-holding part, so as to fit the fruit's various size and keep the holding force constant. Besides, the holding and separating force parameters were calculated based on the measuring result of the fruit material characteristics, so that the holding operation is reliable and nondestructive. Finally, the end-effector's performance was tested, and the result showed the successful picking rate was 86%.

© 2016, IFAC (International Federation of Automatic Control) Hosting by Elsevier Ltd. All rights reserved.

Keywords: tomato, picking end-effector, flexible operation, automatic harvesting, agricultural robot

1. INTRODUCTION

Tomato is one of the worldwidely common vegetable due to its delicious taste, rich nutrition, convenient edible, and the output accounts for 10% of total output of vegetable. However, tomato picking basically depends on manual picking – a kind of time-consuming and labour-consuming mode. And also, the picking cost is increasing as the acceleration of urbanization. The research on automatic picking robot for releasing human labor has been a hotspot worldwide issue in recent years.

The end-effector is the critical component directly operating the fruit. Due to the complexity in working environment, irregularity and flaccidity of operation object (Chen), the end-effector should be accurate and flexible. The national and foreign research institutes have conducted a lot of research on picking robot end-effector since 1980s, and the multiple intelligent end-effectors were designed. At present, the type of robot end-effector includes sucker type (Monta, Liu), shear type (Naoshi, Ma, Zhang), spiral twisting type (Monta, Chen, Tu), multi-fingered type (Ling, Jin). Kondo designed a kind of double-fingered end-effector with soft gasket aspirator (Monta). The aspirator is used to separate the adjacent fruits. And the wrist joints of manipulator are used to twist the connection of fruit stem. The end-effector designed by Ling (USA) has four fingers in uniform distribution and the fingers will bend and hold driven by a cable (Ling). Liu achieve the separation of fruit from stalk by laser cutting (Liu).

In this paper, a new end-effector was designed on the basis of measurement of mechanical property of tomato, which could pull the stalk from the fruit to guarantee the transportation and storage quality. And the performance was tested in the final.

2. Work condition and harvesting robot

2.1 Work condition

The work condition for tomato harvesting robot is shown in Fig.1. The harvesting robot is supposed to move on the rails to pick tomatoes in its both sides. As a new cultivation model, the tomato stem is hung with the top of greenhouse by the string, so that the tomatoes could be fixed in the certain height above the rail through releasing the string.

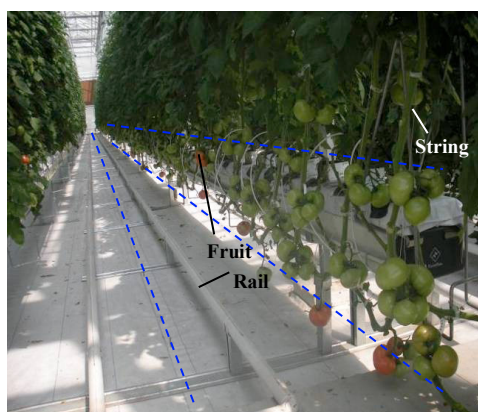

Fig.1 Work condition

2.2 Harvesting robot system

The model of tomato harvesting robot is shown in Fig.2, which contains a vision unit, a jointed manipulator, a railed vehicle, a controller and the end-effector. The vision unit is used to identify and locate the mature fruits. The controller receives and processes image data from vision unit, then sends control signal to the manipulator, the end-effector and the vehicle through CAN bus. The vehicle carries the whole system moving on the rail, until receives the stop signal from

the controller when the mature fruits were identified in the camera field. The jointed manipulator positions the end-effector to approach the target fruit, and moves it back to the container after the fruit is picked by the end-effector.

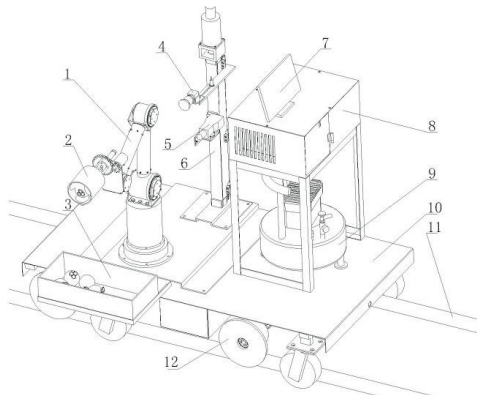

Fig.2 Tomato harvesting robot model

1.Manipulator 2.End-effector 3.Fruit container 4.Camera
5.Laser projector 6.Slider unit 7.Human interface
8.Controller 9.Air pump 10.Vihecle 11.Rail 12.Rail wheel

3. Mechanical property test

3.1 Test materials and equipment

The fruit material used in the test is Jiali No. 14 tomato. According to the ripeness of tomato, randomly select 30 fruits in green ripe stage, preliminary ripe stage, semi-ripe stage and ripe stage respectively.

3.2 Parameter measurement of fruit appearance

Analyze and summarize the measurement results to obtain the physical parameters, as shown in table 1. The friction coefficient between fruit (or stalk) and different materials is shown in table 2.

Table 1. Table of physical parameters of tomato fruit

	Maximum	Minimum	Average
Horizontal diameter(mm)	72.1	58.2	65.5
Vertical diameter(mm)	60.4	48.5	54.2

Table 2. Table of friction coefficient

	Stainless steel	Silica gel	Rubber
Fruit	0.48	0.87	0.8
Stem	0.21	0.25	0.43

3.3 Stalk tensile test

The test uses 1KN range sensor and the rate of loading is set as 1mm/s. Conducting separation layer tensile test and calyx tensile test on different ripeness of tomato respectively, get the range of pulling strength in separation layer is 9.7-28.1N and the average pulling strength is 12.2N; the range of pulling strength in calyx is 12.5-36.6N and the average

pulling strength is 16.2N. Therefore, end-effector uses separation layer pulling mode to separate fruit and stalk, and the maximum pulling strength is set as 30N.

3.4 Compression characteristic test

The test uses 1KN range sensor and the rate of loading is set as 5mm/s. According to the ripeness, the fruits are divided to four groups and each group has 30. Then each group is divided into 3 subgroups randomly and each subgroup has 10. The compression test of different materials will be conducted. Because the gasbag clamps fruit horizontally during picking process, horizontal compression test is conducted. From the test, we get the range of damage of pressure force is 60-314N and the average damage of pressure force is 139N. Therefore, we set the minimum damage of pressure force as 60N.

4. Design of end-effector

4.1 Major structure and working principle

The end-effector mainly consists of a fruit stalk clamping mechanism, a fruit clamping mechanism, a separating mechanism and a control unit. The major structure is shown in Fig.3, where, the base is fixed on the end of mechanical arm and the relative rotation of fixed tray and rotating tray may achieve the close and open of clamping pliers. A pressure sensor is pasted between outer layer of gasbag and fruit, which is used to detect the pressure when clamping fruit. An infrared sensor is equipped on the bottom of sleeve, which is used to detect whether the fruit is in the sleeve. Hall sensor is installed on the stroke end of the gear and cylinder, which is used to detect the clamping state of clamping pliers and the extension state of cylinder.

When the fruits access sleeve, the infrared sensor will detect the fruit and control the air compressor to inflate the gasbag, and DC motor drives clamping pliers to correctly clamp the stalk. The pressure sensor may detect the pressure between fruit and gasbag to ensure no damages on fruit on the premise of reliably clamping fruit. Until getting stability, then drive the double-acting cylinder to take the sleeve to shrink, in order to cut off and pick the fruit.

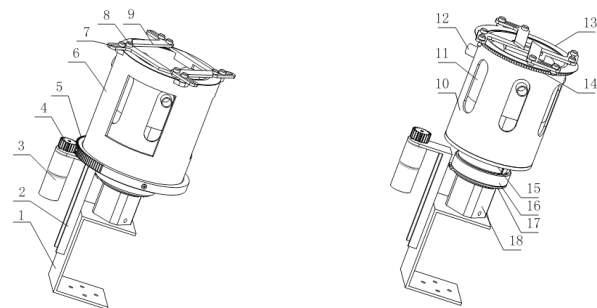

(a) Clamp mechanism opens (b) Clamp mechanism closes
Fig.3. Schematic diagram of end-effector.

1. Base 2. Motor fixed plate 3. DC motor 4. Driving gear
5. Driven gear 6. Rotating tray 7. Clamping pliers 8. Pin
9. Toggle clamp 10. Fixed tray 11. Sleeve 12. Gasbag

Download English Version:

<https://daneshyari.com/en/article/5002415>

Download Persian Version:

<https://daneshyari.com/article/5002415>

[Daneshyari.com](https://daneshyari.com)